

BOROUGH OF NORTHAMPTON
BUREAU OF INSPECTIONS
PLUMBING DIVISION

APPLICATION FOR PLUMBING PERMIT

	New Building	Addition	Old Building	Permit #
Number of Stories				Fee
Use of Building				Date

The undersigned applies for a permit to construct the following plumbing work:

LOCATION _____

**** DRAWING MUST BE COMPLETED ON THE REVERSE SIDE OF THIS APPLICATION.

TABLE OF FIXTURES

FLOORS	1st	2nd	3rd	4th	5th	Yard	Basement
Water Closets							
Wash Basins							
Bath Tub							
Shower							
Sinks							
Automatic Washer							
Slop Sink							
Laundry Trays							
Floor Drain							
Urinals							
Dishwasher							
Garbage Disposal							
Drinking Fountain							
Outlets							
TOTAL							

**** If anything is in the basement floor, a plumbing release form must be signed by the owner.

Is connection to be made to sewer? <input type="checkbox"/> Yes <input type="checkbox"/> No	Main Trap Size	Main House Drain <input type="checkbox"/> Above <input type="checkbox"/> Below <input type="checkbox"/> Ground <input type="checkbox"/> Ground
Soil Pipe Size	Where does air inlet open?	Building Permit Number <input type="checkbox"/> Yes <input type="checkbox"/> No Date _____

All proposed work under this application must be shown on plans and section. All vertical lines of soil, waste, leader and refrigerator pipes shall be designated by numbers or letters. A soil or waste line and its attendant vent line may be considered as one stack and so numbered or lettered.

All work, materials, and construction will be in accordance with the rules and regulations of the plumbing code.

**** PLUMBER must be licensed with the Borough of Northampton.

Owner _____

Plumber _____

Address _____

Address _____

Daytime Phone _____

Daytime Phone _____ Reg. # _____

PERMIT NUMBER _____

ADDRESS _____

ELEVATION

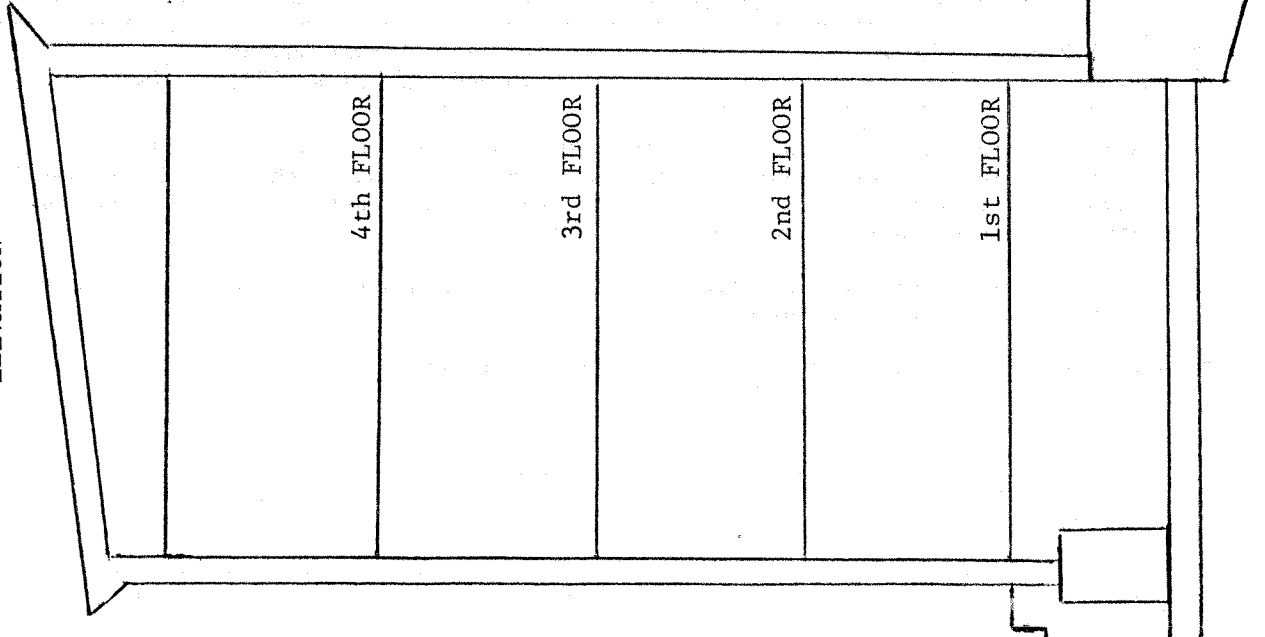

FLOOR PLAN

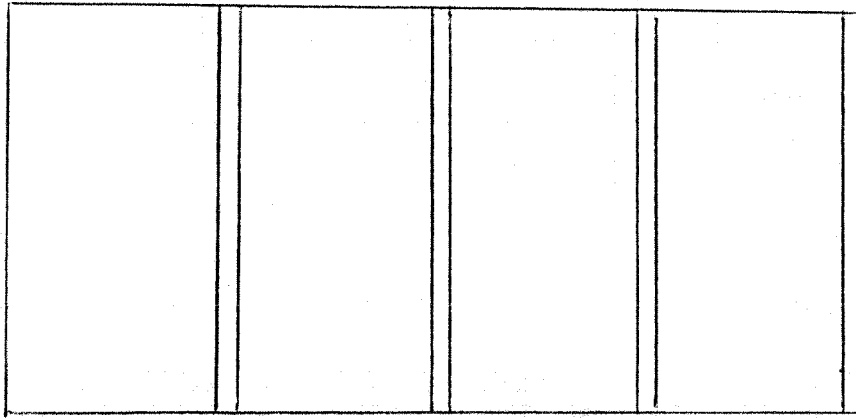

CELLAR PLAN

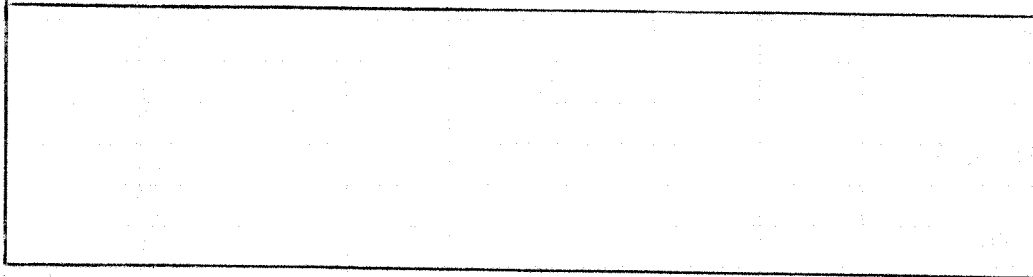

EXAMINER'S REPORT

Northampton

19

This is to certify that I have examined this detailed statement together with a copy of the plans and specifications relating thereto and find the same to be in accordance with the specifications covering the rules and regulations of the Plumbing Code and entered into the record of this department.

Examiner

INSPECTOR'S REPORT

Inspected Main Trap _____
 Inspected Underground Work _____
 Inspected Vertical Soil Pipes _____
 Inspected Waste Line Pipes _____
 Inspected Tests _____
 Remarks _____

This is to certify that the plumbing work constructed under this permit has been finally inspected and all work found in accordance with the approved plans and specifications covering the rules and regulations of the Plumbing Code.

Inspector

Date

_____, 19